

MADE IN SPAIN

**CARDANS**



610 LED  
611 LED



610 GU 5.3  
611 GU 5.3



610 GU 10  
611 GU 10

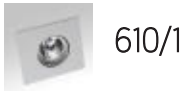

610/1

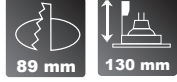

610/2



611/1

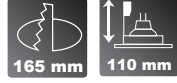

611/2



CARDAN 90 1/2 LED



CARDAN 90.1

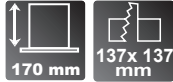

CARDAN 90.2



CARDAN MINI 1 GU 5.3  
CARDAN MINI 2 GU 5.3



CARDAN MINI 1 GU 10  
CARDAN MINI 2 GU 10



CARDAN MINI 1



CARDAN MINI 2



RINGO TILT LED



RINGO TILT GU 10



RINGO TILT 01/1



RINGO TILT 01/2



RINGO TILT 01/3



RINGO TILT 02/1



RINGO TILT 02/2



RINGO TILT 02/3



RINGO BOX LED



R.BOX 1.1 /1.2 GU 10

R.BOX 1.1 /1.2 F. GU 10



RINGO BOX 1.1



RINGO BOX 1.2



RINGO BOX 2.1

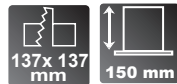

RINGO BOX 2.2



RINGO BOX 1.1 Frameless



RINGO BOX 1.2 Frameless



RINGO BOX 2.1 Frameless



RINGO BOX 2.2 Frameless

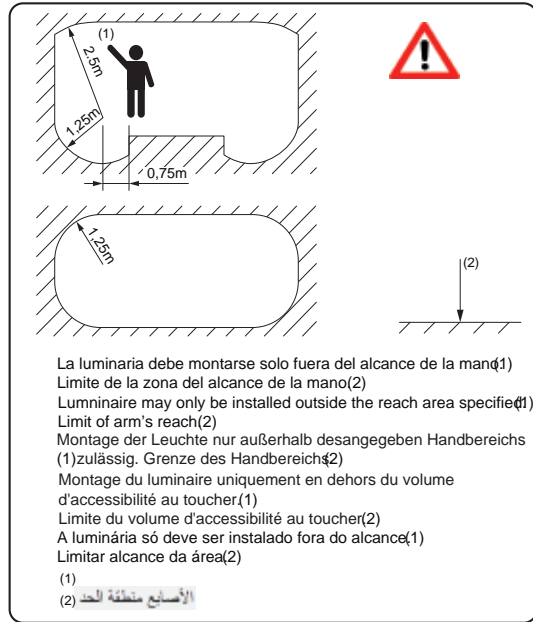
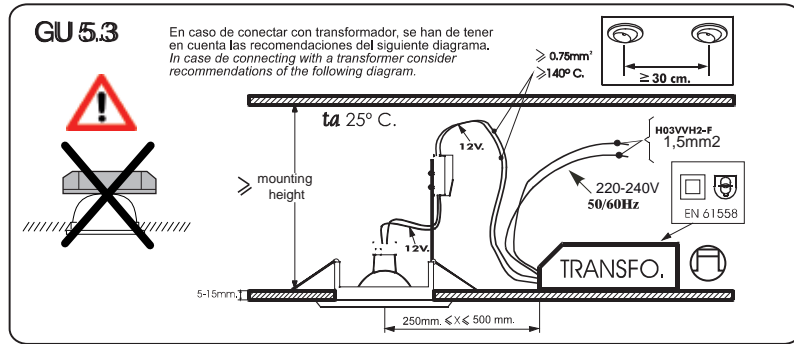
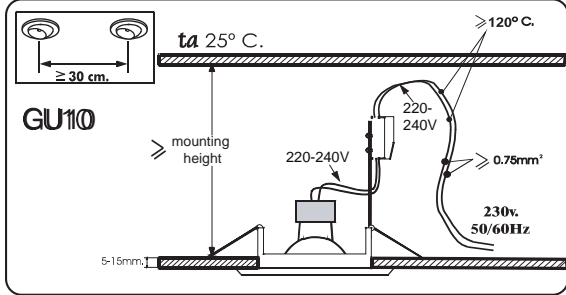
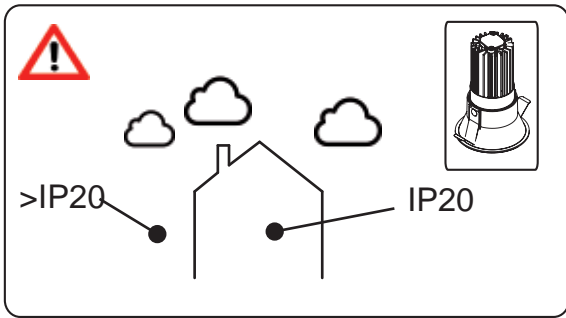
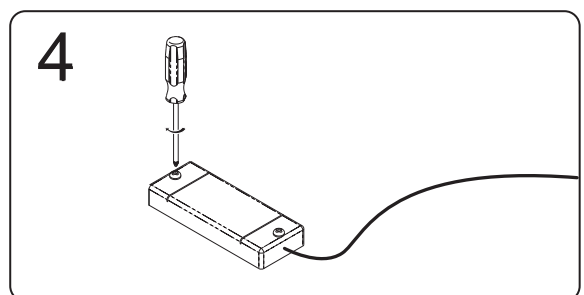
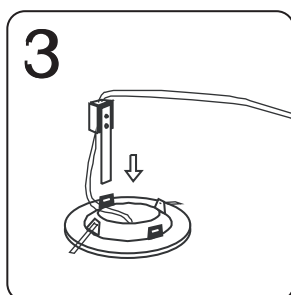
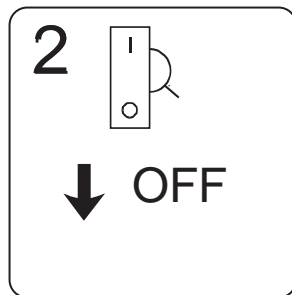
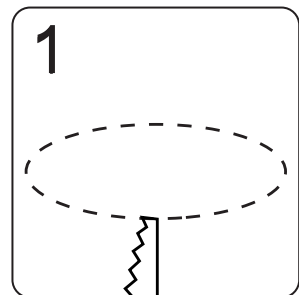
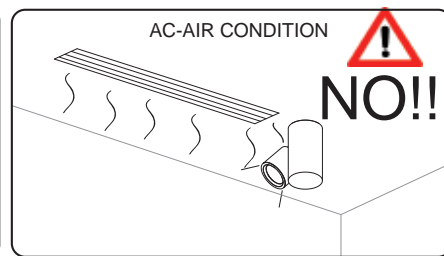
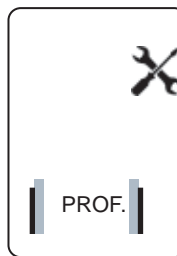
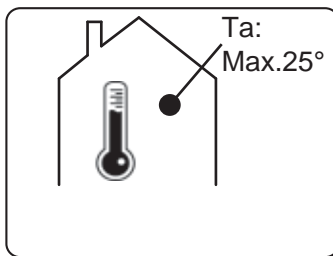
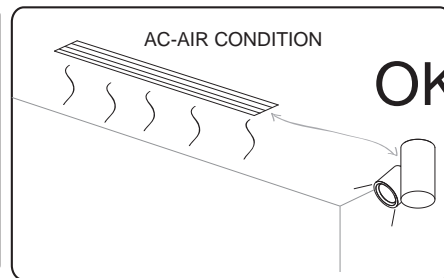
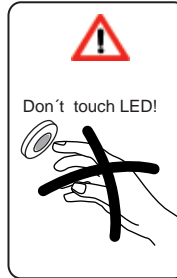
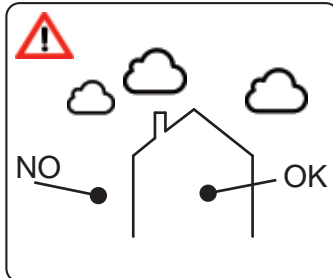

**CARDANS**

**CARDANS**

4

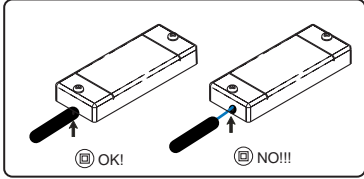
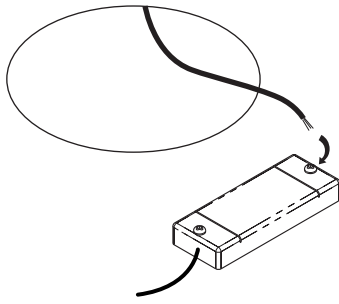

No usar otro convertidor que el suministrado por onok.  
Do not use another drive that provided by onok.  
Verwenden Sie keine anderen Treiber, die von onok bereitgestellt  
Ne pas utiliser un autre pilote qui est fourni par onok.  
Não use outra conversor que não seja o fornecido pela OnOK.

\* driver no dimmable:

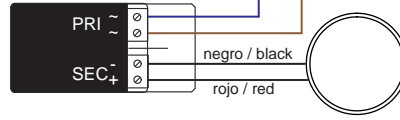

\* driver dimmable 1-10 V:

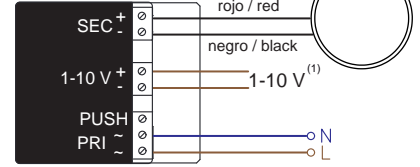

\* driver dimmable DALI:

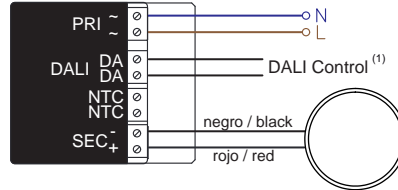

\* driver dimmable PUSH:

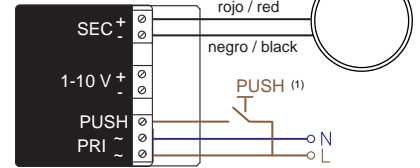

**⚠** DALI/PUSH/1-10V<sup>(1)</sup>

**SP** Mantener el aislamiento reforzado entre la alimentación en baja tensión (BT) y los conductores de control.  
Maintain the insulation reinforced between the low voltage supply (LV) and the control conductors.  
Pflügen verstärkte Isolierung zwischen der Niederspannungsversorgung (BT) und dem Steuerleiter.  
Maintenir une isolation renforcée entre l'alimentation basse tension (BT) et les conducteurs de commande.  
Manter isolamento reforçado entre a alimentação de baixa tensão (BT) e os condutores de control.

**AR**

5



6

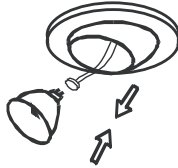

7

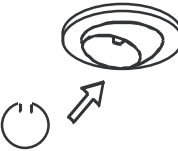

7.1

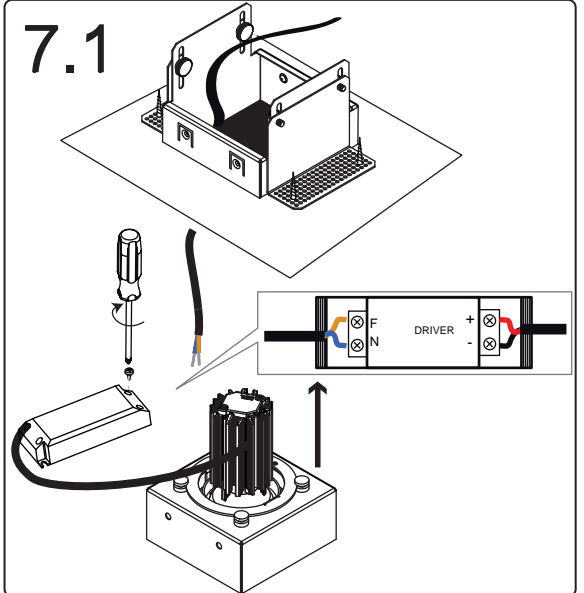

5

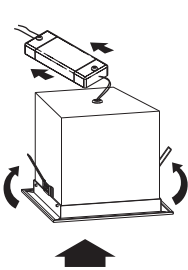

6

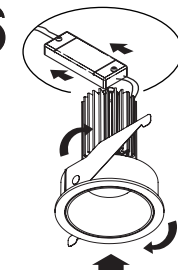

7.2

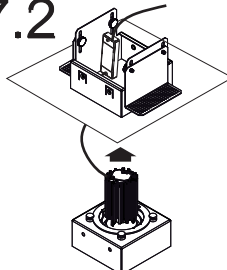

5

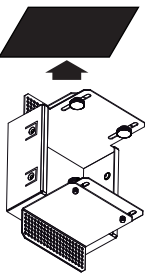

6

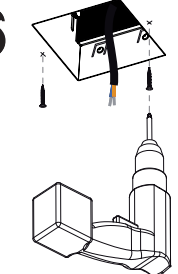

7.3

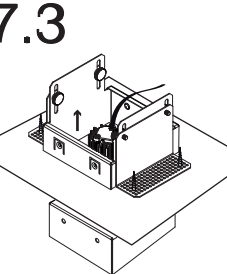

8

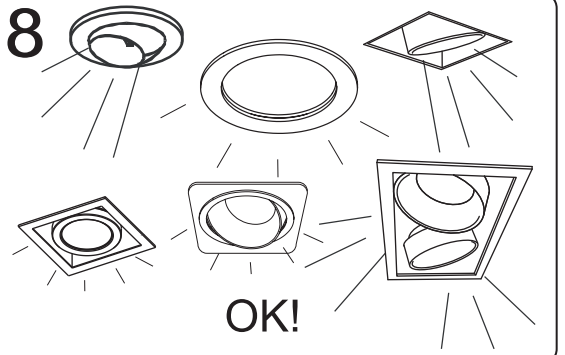

5.1

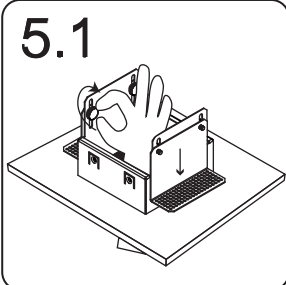

6.1

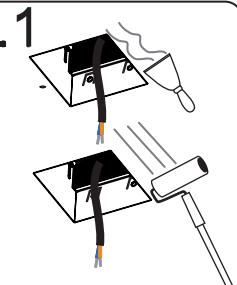

7.4



9

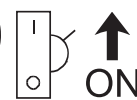

**SP** No mire directamente la fuente de luz.  
Do not look directly the light source.  
Schauen Sie nicht direkt die Lichtquelle.  
Ne pas regarder directement la source lumineuse.  
Não olhe diretamente para a fonte de luz.